

OPENING YOUR TREAT KIT PACKAGE

1. Remove your new treat kit from the protective poly bag.

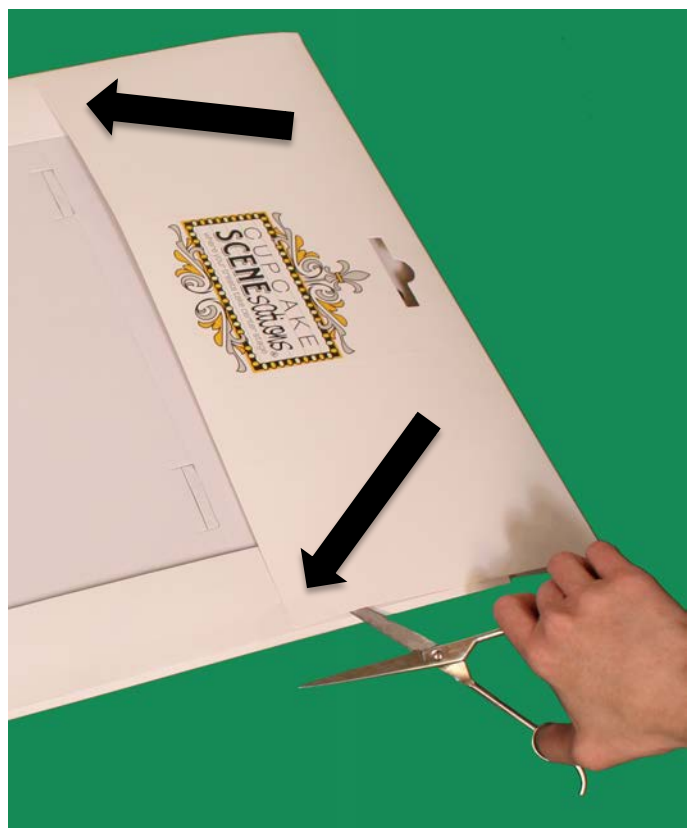

2. Carefully use scissors or another safe cutting tool to break the seal on each side of the upper flap.



3. Gently pop up and remove the staple on each side.

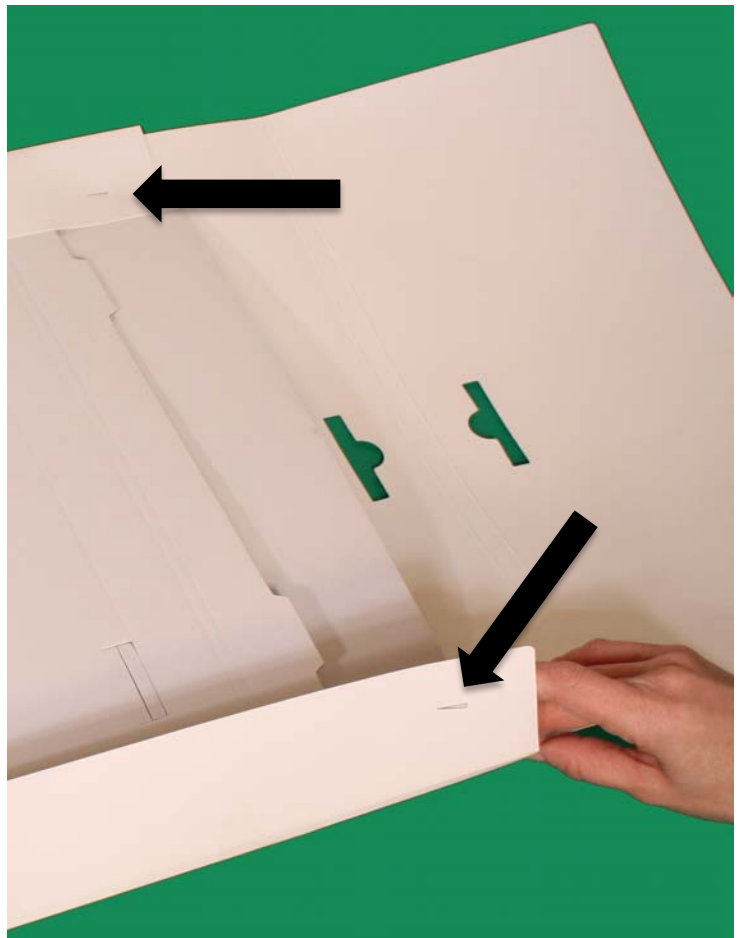

4. Remove the bottom tray and set it aside.



5. Next, remove the box lid and set it aside.

The treat kit shown here is our *Down On The Farm* themed kit. All kits are packaged in a similar fashion. Your kit may have different pieces than shown here, depending on which one you selected.



6. Lastly, remove the treat insert and set it aside.



7. Leave the kit pieces in the packaging for now. You will remove those later to decorate your treat box.



ASSEMBLING THE BOTTOM TRAY

1. With the logo side up, begin folding the side flaps up, pressing them in and towards the center of the tray.

(The logo side of the bottom tray has a special coating to help protect against simple grease stains and frosting spills. You can easily wipe those things off with a soft cloth or paper towel).



2. Fold the small tray end flaps in towards the center of the tray.



3. Continue the process by folding the shorter end flap.

There is a small two-seam ridge, so be sure to fold on both seams to ensure the end piece will fold over correctly and that the tray will be securely assembled.

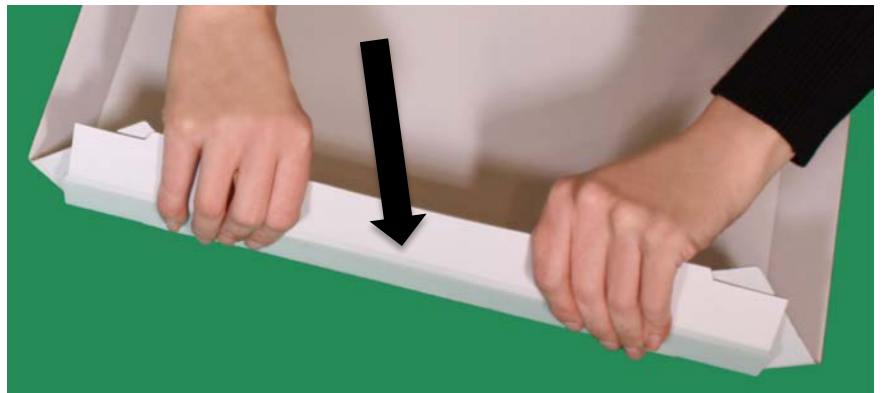

4. Fold the small tray end flaps in and push down through the small slits. A little white cut-out piece should pop out from each side.



5. Hold the tray tabs down and fold the end flap up and over the small tray end flaps.



6. Continue folding the end flap over, pushing the two outer tabs down into the holes.



7. Press in to ensure that the end flap is securely in place.



8. Take the sides of the tray and press in gently. Adjust each until both sides are straight.



9. Repeat steps 2 through 8 to complete the other end of the tray.

PLACING THE TREAT INSERT INTO THE BOTTOM TRAY

1. Start by folding the side flaps in, pressing them in and towards the center of the treat insert.



2. Turn the insert over and make sure all four (4) side flaps are turned down. Place the treat insert into the tray.

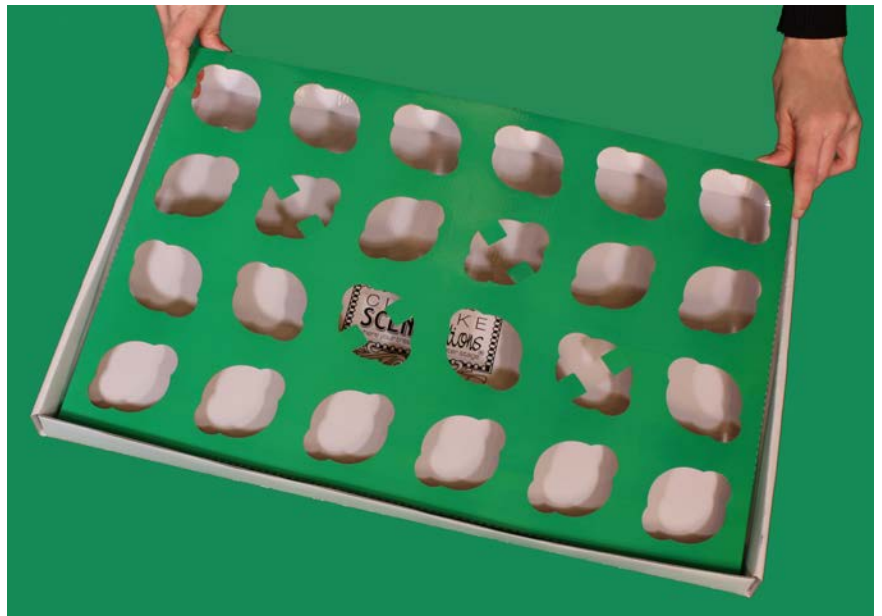

3. There are eight (8) small tabs on the treat insert. These tabs will help keep the treat insert level, which will help hold your treats in place. Press each tab down so they touch the tray.



ASSEMBLING AND INSERTING THE TREAT DIVIDERS INTO THE TREAT INSERT, THEN PLACING IN THE BOTTOM TRAY

If your kit has three (3) long treat dividers (ex. Fence pieces for the Down On The Farm kit or Flower pieces for the Sweet As Can Bee kit), follow these instructions to insert the divider holders and secure the treat dividers in place.

1. There are nine (9) small divider holders. These holders are placed up through the bottom of the treat insert. They hold the long treat dividers in place.

Start by inserting each divider holder from the bottom of the treat insert.



2. Make your way across each of the three (3) rows, inserting the divider holders as you go.



3. Continue inserting the divider holders until all nine (9) are in place.

TIP: If a holder is not fitting firmly into the insert, place a small piece of tape on the bottom side to fasten it to the insert.

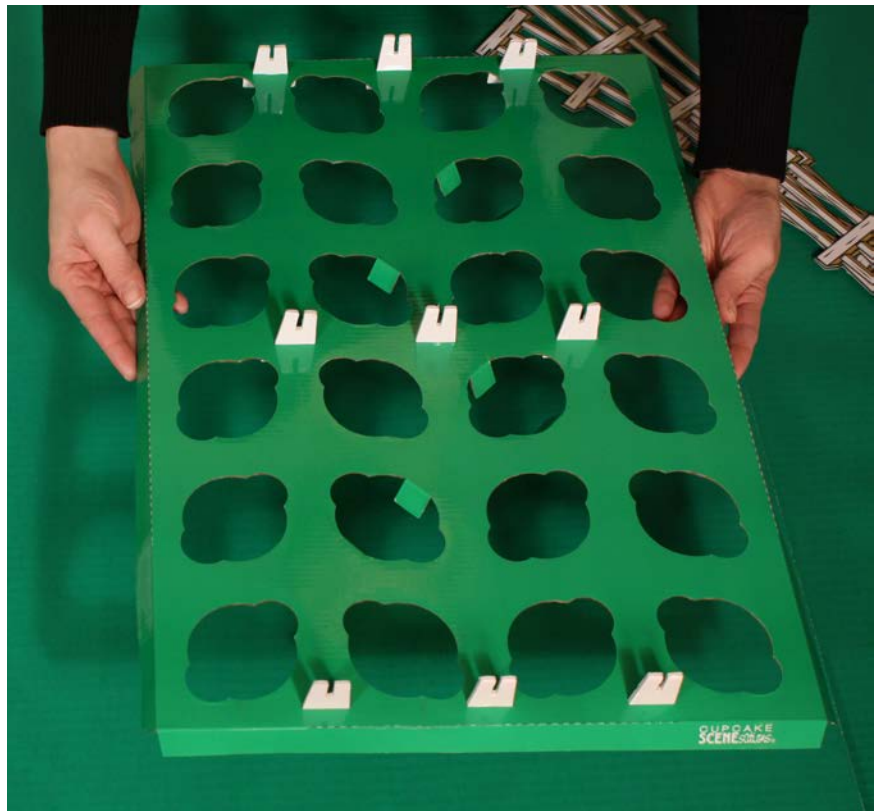

4. Place the completed treat insert with holders into the tray.

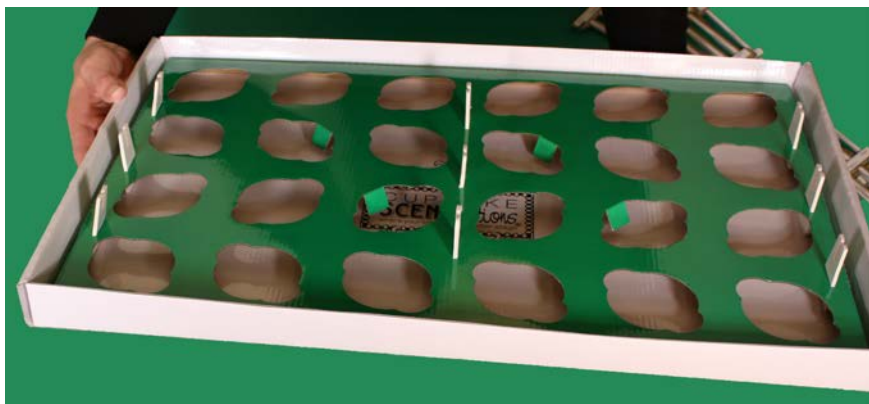

5. Take one of the long treat dividers and line it up with the first line of divider holders. Start at one end and insert the divider into the holder by lining up the small slits. Gently press down to fit the treat divider into the holder. Don't press all the way down at this time, just set it in until you have the other two (2) dividers in place.

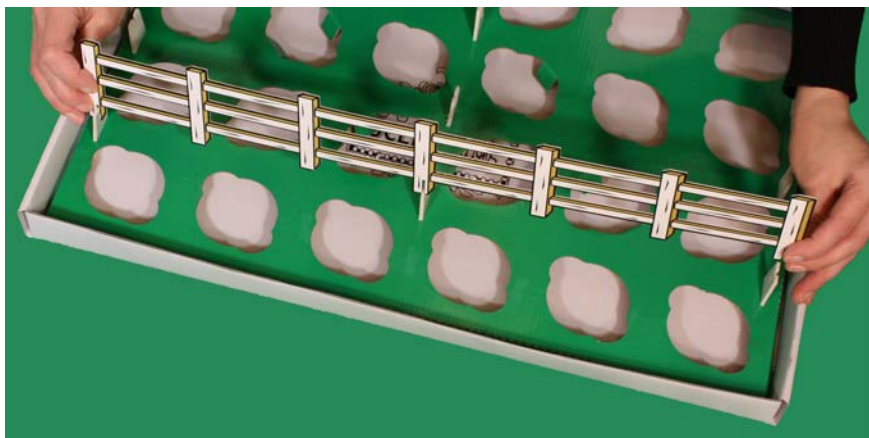

6. Continue to the middle divider and repeat the process.



7. Finish the process on the other end.



8. Take the treat divider and press gently, but firmly, in place. You don't have to push all the way down, as they don't have to sit flush with the tray. You just don't want them to move around.



9. Repeat steps 5 through 8 to attach the other treat dividers.

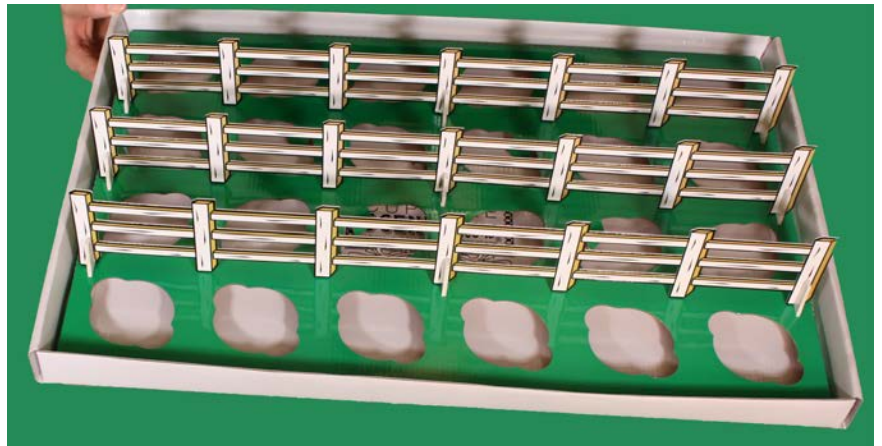

ASSEMBLING THE BOX LID

1. Begin this process working on one end at a time. Start by folding the end flaps up, pressing them in and towards the center of the lid.



2. Continue the process by folding the shorter side flaps in towards the center of the lid.



3. There are three (3) lines of adhesive on each of the side flaps. Starting with one side, peel away the paper from the first strip to reveal the adhesive.

Important Tip: Work on one side at a time. Do not peel off all of the paper strips from all of the adhesives at the same time.



4. Continue with the second line of adhesive, peeling away the paper from the strip.



5. Finish with the third line of adhesive, peeling away the paper from the strip.



6. Repeat steps 3 through 5 for removing paper strips the other side flap.

7. Line up the side flaps with the seam on the end of the box lid.

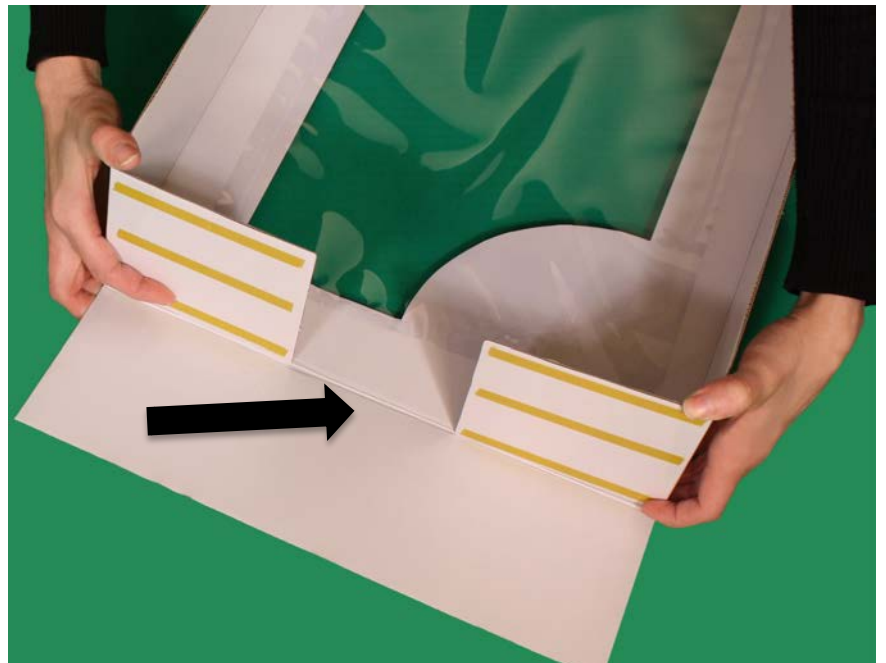

8. Bring the end flap up and press firmly to the adhesive.



9. Turn the box lid on end and press down firmly to seal.



10. Repeat steps 1 through 9 for the other side of the box lid.
11. Place the box lid on top of the bottom tray with the treat insert.

TIP: We recommend leaving the box lid on immediately after assembly (as shown here) to create a firm seal. If necessary, you can press the sides together to re-seal and secure the flaps.



CONGRATULATIONS!

You've assembled your very own Cupcake SCENEsations® Treat Kit box with insert! Now comes the fun part! You get to DECORATE it!

DECORATING TIPS

All of our treat kits come with one (1) front design, four (4) border pieces and 24 assorted treat toppers. We recommend using a glue stick to apply the border pieces first (starting at the top), then apply the front design. If you purchased a sports kit, the end pieces (football goal, basketball goal, etc.) can be secured upright to the side of the bottom tray with glue dots or double-stick tape. Insert the treat toppers as desired.

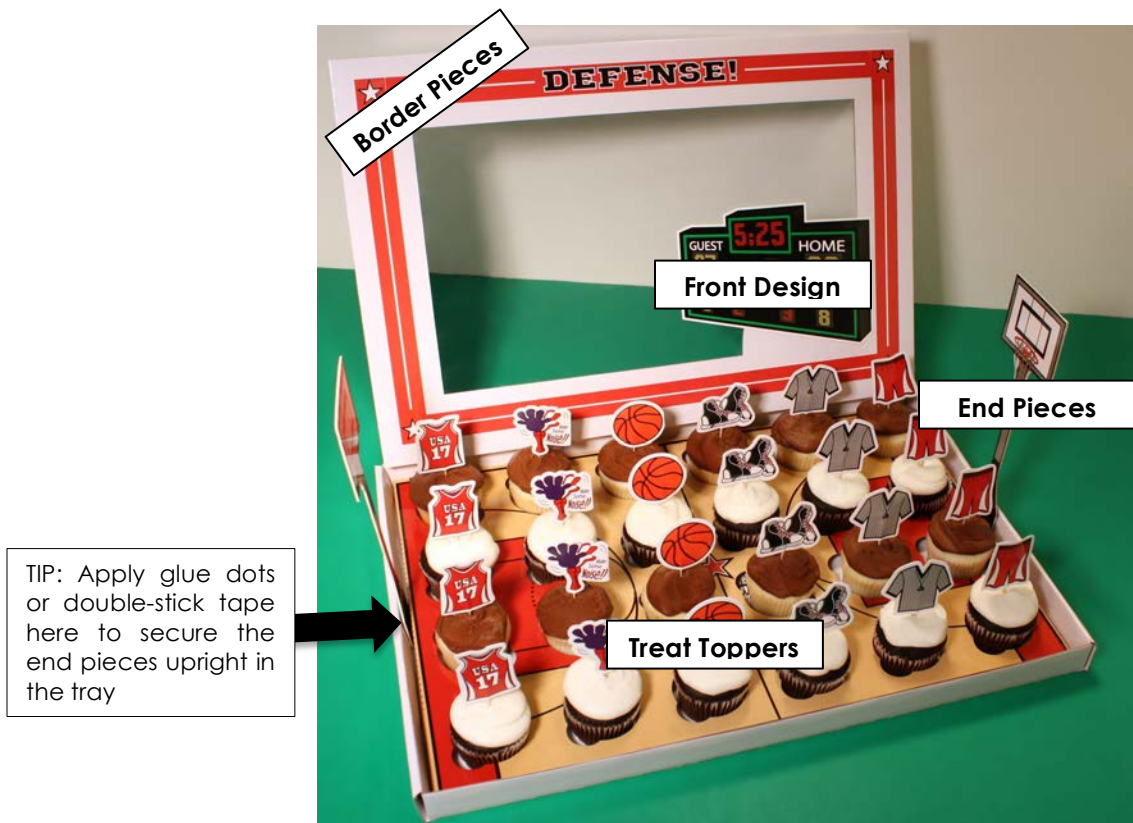

For decorating ideas, photos or information on any of our products, please visit our website at www.cupcakescenesations.com

